

+39 3283792917

info@verdeabitare.it

REF 396 Two houses with extensive grounds, ideal for running a B&B or holiday business



Property Lot Size	70000 m ²
Property Size	1000 m ²
Rooms	28
Bedrooms	8
Bathrooms	4

Other characteristics:
attic, balcony, basement, cellar, pool, terrace.

More infos

Set beautifully within its plot, REF 396 is found at the top of a stunningly panoramic hilltop. Nearby are wonderful and accessible country walks, many facilities and amenities are within a short drive, like known restaurants and wineries, and the charming town Casale Monferrato is within very easy reach. The village is within walking distance. Entering the house via the front door, you are greeted by a superb hallway with grand staircase. On this floor there are two grand salons with original ceilings and frescoes, and the main apartment with original features and frescoed ceilings.

The estate comprises a main apartment and 3 more units, and is composed of three buildings:

The main house comprises a master apartment (with frescoes), a guest accommodation, and a maid apartment (with separate entrance from the rear side only), then a second building (this again with terrific views) in front of main house composed of another guest 2 beds accommodation and a indoor pool ground floor (the pool needs some jobs)

There is aside another outbuilding used currently as carbox, formerly used as tractor box.

A very low traffic road leads to the rearside of the property, where there is a small plot of land used as car parking area.

The property stands within its own 70,000 sqm well kept grounds.

It is the ideal property for a B&B or a boutique hotel. To restore

Property cost

€ 390.000

Agent commission

3% plus VAT

+39 3283792917

info@verdeabitare.it

Cadastral map and floor plan

Address:

15020 San Giorgio Monferrato AL

Latitude and Longitude: 45.107718064032944 | 8.413623648966304

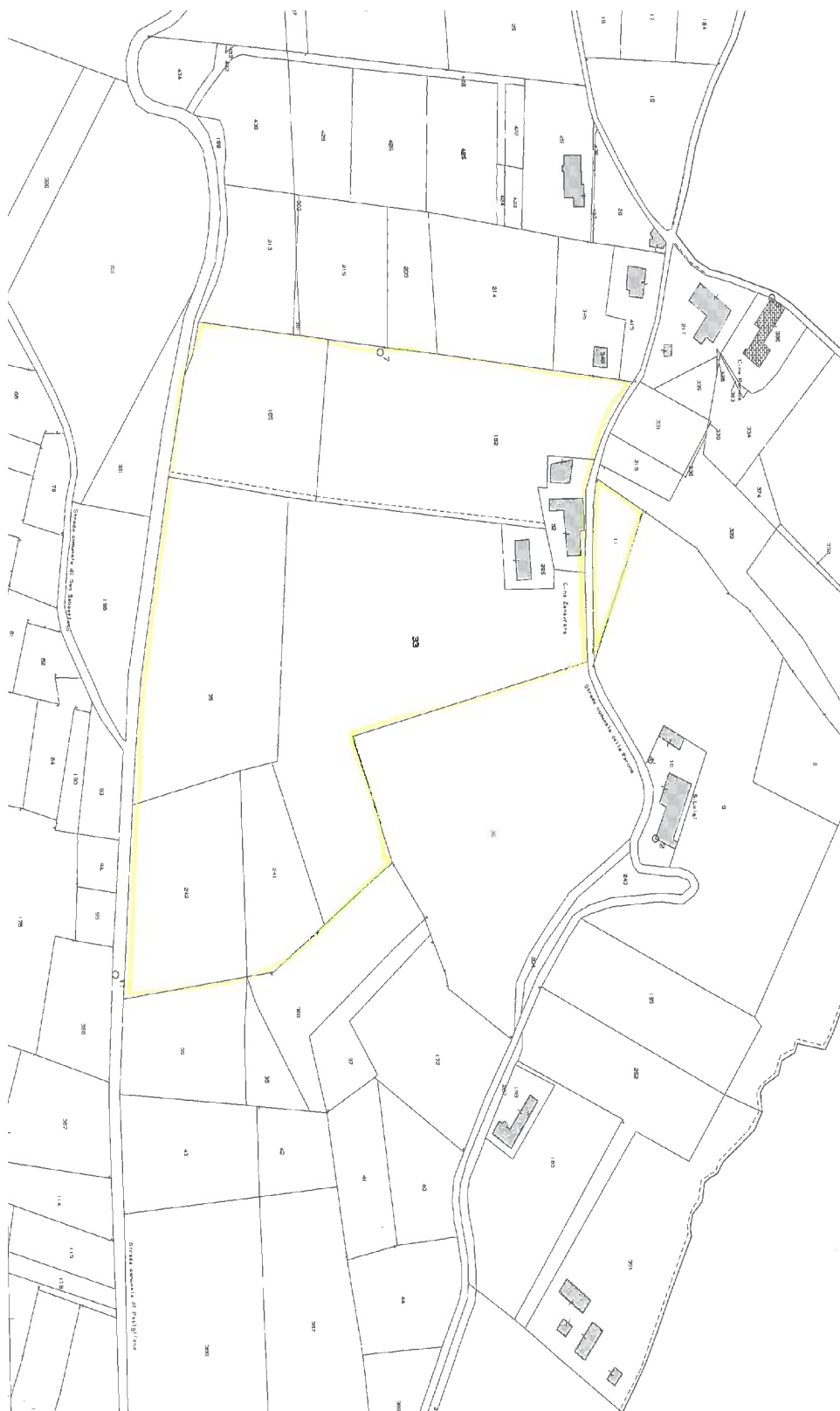

+39 3283792917

info@verdeabitare.it

Cadastral map and floor plan

Address:

15020 San Giorgio Monferrato AL

Latitude and Longitude: 45.107718064032944 | 8.413623648966304

